

Printed Pages – 6

Roll No.

320714(20)

B. E. (Seventh Semester) Examination, 2020

APR-MAY

(Old Scheme)

(Civil Engg. Branch)

QUANTITY SURVEYING and COST EVALUATION

Time Allowed : Three hours

Maximum Marks : 80

Minimum Pass Marks : 28

Note : Attempt all questions. Part (a) from each question is compulsory. Attempt any two parts from parts (b), (c) and (d) of each question.

Unit-I

1. (a) What do you understand by unit of measurement? 2
- (b) Write units of measurement of various items of work : 7
 - (i) Earth work in excavation

320714(20)

PTO

- (ii) Cement concrete
 - (iii) D.P.C.
 - (iv) Half brick work
 - (v) Rolled steel channels
 - (vi) Marble flooring
 - (vii) White washing
- (c) Write short notes on the following : 7
- (i) Revised estimate
 - (ii) Supplementary estimate
- (d) Write short notes on : 7
- (i) Master Roll
 - (ii) Competent authority
 - (iii) Deposit work

Unit-II

2. (a) What do you understand by detailed estimate? 2
- (b) Explain following terms : 7
- (i) Long wall-short wall method
 - (ii) Centre line method

- (c) Estimate the following items of work for a single room 6 m × 4 m building as per given cross-section of wall and foundations as shown in fig. by long wall short wall method : 7
- (i) Earthwork in excavation in foundation
 - (ii) Concrete in foundation
 - (iii) Brickwork in plinth and foundation
 - (iv) Brickwork in super-structure

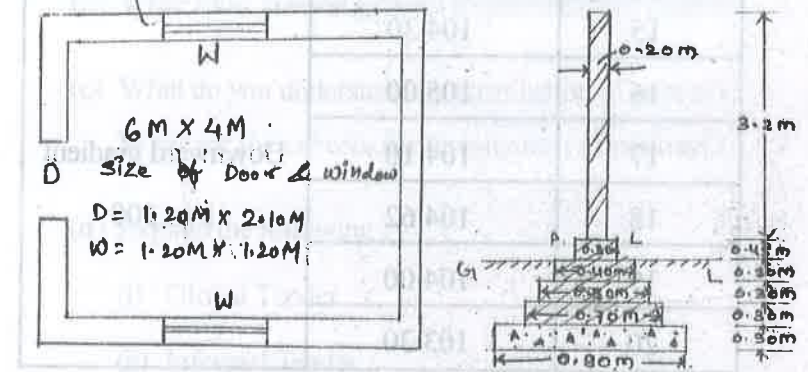

- (d) Reduced level (RL) of ground along the centre line of a proposed road from chainage 10 to 20 are given below. The formation level at the 10th chainage is 107 and the road is in down ward gradient of 1 in 150 up to the chainage 14 and then the gradient

change to 1 in 100 downward formation width of road is 10 metre and side slopes of banking are 2 : 1 length of the chain is 30 metre. 7

Chainage	R.L. of Ground	R.L. of formation
10	105.05	107.0
11	105.60	Downward gradient 1 in 150
12	105.44	
13	105.90	
14	105.42	
15	104.30	Downward gradient 1 in 100
16	105.00	
17	104.10	
18	104.62	
19	104.00	
20	103.30	

Unit-III

3. (a) What is the purpose of Rate Analysis? 2
- (b) Analysis the rate of cement concrete 1 : 2 : 4 per unit. Use 10 cubic metre for calculation purpose. 7

- (c) Prepare analysis of rate for the following items of work. Assume suitable rates of materials and labour for 1st class brickwork and 1 : 6 in super st. 7
- (d) Write detailed specifications of cement concrete flooring. 7

Unit-IV

4. (a) What is a Contract? 2
- (b) Write short note on general requirements of contract. 7
- (c) What do you understand by termination of contract? What are the criteria for termination of contract? 7
- (d) Explain the following : 7
- (i) Global Tender
 - (ii) Informal Tender
 - (iii) Unbalance Tender
 - (iv) Notice inviting Tender

Unit-V

5. (a) What do you understand by the term Valuation? 2

(b) Define the following terms : (any four) 7

(i) Book value

(ii) Annual value

(iii) Market value

(iv) Scrap value

(v) Sinking fund

(c) Write short notes on : 7

(i) Mortgage

(ii) Easement

(iii) Year purchase

(d) Define object of valuation of property. 7